

OCO-M25BGS

Low G-sensitivity OCXO
Sine wave



Features

- Ultra Low G-sensitivity option
- Low Phase Noise

Parameter	Specification					
	OCO-M25BGS12					
Frequency Range	80.000 ~ 125 MHz					
Standard Frequencies	100.000MHz 120.000MHz					
<u>Operating Temperature Range</u> Code	EH	GH	JK	NK	NN	Z
	0 / +60	-10 / +60	-20 / +70	-40 / +70	-40 / +85	Custom
Frequency Stability Code	50n		20n		10n	
vs <u>Operating Temperature Range</u>	$\leq \pm 50 \times 10^{-9}$		$\leq \pm 20 \times 10^{-9}$		$\leq \pm 10 \times 10^{-9}$	
vs. Supply Voltage change [Vdc] $\pm 5\%$	$\leq \pm 1 \times 10^{-8}$					
vs. Load change $\pm 5\%$	$\leq \pm 5 \times 10^{-9}$					
vs. Aging after 30 days of operation	$\leq \pm 2 \times 10^{-7}$ 1 st year					
G-sensitivity Code	G1		G2		G3	
Worst axis	$\leq 8 \times 10^{-10}/g$		$\leq 5 \times 10^{-10}/g$		$\leq 3 \times 10^{-10}/g$	
Output waveform	Sine wave					
Output level	> +7 dBm					
Output load	50Ω $\pm 5\%$					
Harmonics	< -30 dBc					
Sub-harmonics	< -90 dBc					
Supply Voltage [Vdc]	+12.0 V $\pm 5\%$					
Steady-state current consumption @ +25 °C	< 170 mA					
Warm-up current consumption @ +25 °C	< 370 mA					
Warm-up time @ +25 °C	< 300s		< $\pm 1 \times 10^{-7}$			
Electronic Frequency Control [EFC] range	> $\pm 1 \times 10^{-6}$ positive slope					
Voltage Control [Vc]	0 ~ +10.0 V					
Reference voltage output [Vref]	+10.0 V					
Phase Noise @ 100MHz dBc/Hz		Typical			Maximum	
	10 Hz	-105			-100	
	100 Hz	-135			-130	
	1 kHz	-165			-160	
	10 kHz	-175			-170	
	100 kHz	-177			-175	
Storage temperature range	-55 ~ +85 °C					
Vibration	acceleration: 10 g; 10 Hz up to 200 Hz and down to 10 Hz; all 3 axes					
Shock	100 g, half-sine, 6 ms					

Note 1: unless otherwise specified conditions are @ 25°C still air

Note 2: all combination not possible (consult factory)

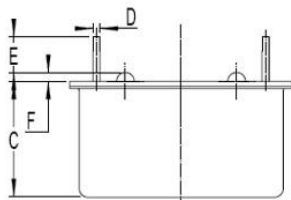

Symbol	Dimension (mm)	
	Min	Max
A		25.6
B	18.80	19.20
C		12.5
D	0.70	0.90
E	4.6	6.2
F	0.4	0.7
G	9.4	9.6
H	11.5 nominal	
I	11.5 nominal	

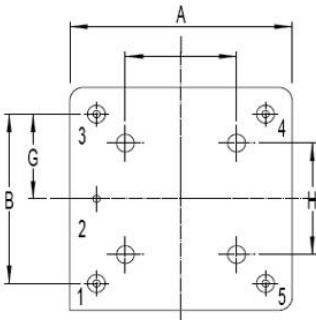

Pin No.	Pin Function
1	Output
2	GND
3	Vc
4	Vref
5	Vdc

Ordering Guide:

OCO-M25BGS12-NN50n-G2-100MHz

Vdc OTR Gsens

Connection circuit

